

PLEASE READ ALL INSTRUCTIONS CAREFULLY BEFORE STARTING TO INSTALL THIS PRODUCT
NO RESPONSIBILITY IS TAKEN FOR DAMAGE CAUSED BY INCORRECT HANDLING, WIRING OR
INSTALLATION

FITTING INSTRUCTIONS

- Ensure that mains supply is disconnected or isolated before commencing work on product.
- Before installing recessed downlights, mark the ceiling with the appropriate 75mm cutout size.
- Before cutting hole, ensure that the hole does not impinge on any joists, water or gas pipes, cables or other hidden objects and that if being fitted into a ceiling tile, it needs to be central with a minimum of 100mm from ceiling rails.
- Ensure that neither downlight nor the driver is covered by thermal insulation when in situ.
- Ensure that there is at least 50mm of free space above and around the downlight to avoid any possible overheating.
- Connect the red cable on the light fitting to the + terminal on the DC output on the driver and the black cable to the - terminal for 0.70A. Now connect the driver to the mains supply: Blue - Neutral, Brown - Live.
- Offer luminaire up to cutout with the longer leg of each spring being held vertically by hand. The luminaire is retained in position by the spring tension between the short and the long leg of each spring against the ceiling. Push the fitting vertically into hole and release springs. See Fig 1 to 3:

CONNECTION DETAILS

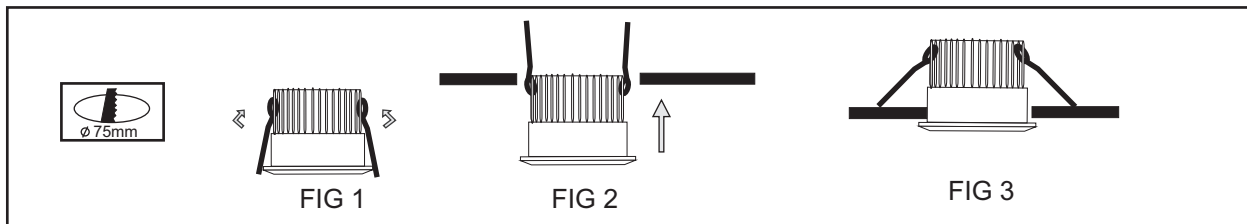

Removal

- To remove downlighter, ensure that mains supply is disconnected or isolated.
- Pull down fitting from ceiling against spring tension, push springs into body.
- Once fitting is down and springs are accessible, hold springs in place while fitting is removed from hole.
- Disconnect mains wires from fitting.

Maintenance

- When operational, luminaries can be hot to the touch. Switch off and allow to cool before undertaking any maintenance work
- Always switch off mains supply before servicing.
- The lamp within this fitting is not a replaceable part
- Disconnect driver from the mains before performing insulation/megger tests to alleviate permanent damage being caused to electronic driver.

Product Specifications. (See data sheet at http://www.istl.com/css/pdf/prod_1380_datasheet.pdf)

WEEE Directive- End of life of product. Please return end of life products back to IST for recycling.

IMPORTANT

DO NOT ATTEMPT TO INSTALL THIS PRODUCT WITHOUT ADVICE FROM A FULLY QUALIFIED ELECTRICAL ENGINEER. FAILURE TO DO SO MAY CAUSE PERSONAL HARM OR DAMAGE TO THE PRODUCT.

IT IS IMPORTANT THAT THESE GUIDELINES ARE FOLLOWED AT ALL TIMES DURING INSTALLATION. THIS INFORMATION IS FOR YOUR SAFETY AND TO ENSURE THAT THE PRODUCT IS INSTALLED CORRECTLY.

THE PRODUCT MUST BE WIRED AS PER THIS DIAGRAM. IF THE PRODUCT IS WIRED INCORRECTLY IT WILL NOT FUNCTION AND CAUSE SEVERE INTERNAL DAMAGE TO THE DEVICE.